

COMMON APPLICATIONS

Internal medium to high security domestic and selected commercial and retail applications. Made to measure in powder coated pre-galvanised steel.

CONSTRUCTION

Lattice

High grade steel in 'X' lattice as standard and 'S' lattice as an option. Weight 19 kg m² nominal

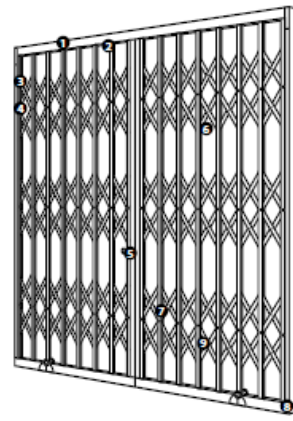
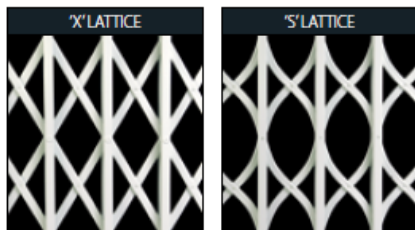

GENERAL ARRANGEMENT

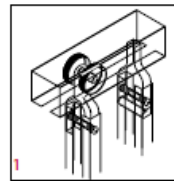

- 1 Top hung on nylon coated steel bearings
- 2 All galvanised steel construction
- 3 Powder coating in a range of colours
- 4 Fits within or around the reveal
- 5 Multi-point locking from single key – 2 point
- 6 Strong steel lattice with smooth durable finish
- 7 Overlapped locking profiles
- 8 Optional folding bottom track
- 9 Steel rivetted lattice assembly system.

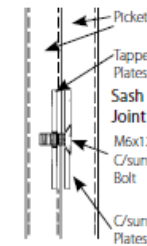
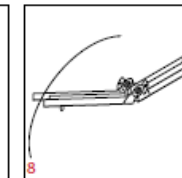
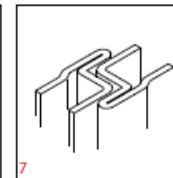
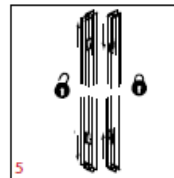

Gate Height Range (mm)	Number of lock hooks available
100	2 (4 optional)
1000-501	2
500-350	Fixed Panel

Please note: SeceuroGuard 1000 can accommodate an unlimited width with multiple sashes. Sashes are made in single pieces up to 2 m wide. Larger sizes are made in sections for assembly on site, ensuring the weight of each section can be handled safely. Gates which are wider than 4 m will be supplied with the top track in two pieces, the split will be in the middle. Where two split sashes meet two pickets are joined together using bolts and fixing plates supplied loose (see illustration above).

OPTIONS

Folding bottom track*		£49.06 per sash
Fixed Panel		Trade discount increased 5%
Removable bottom track		£49.58
Reinforced locking (3 or 4 point)		£65.72
Hinge aside (add lift up bottom track if required)		£139.91 per sash
Additional blank key		£5.02
Handle with fixings (one per sash supplied as standard)		£8.19 each
Reinforced top/bottom track for face fitting		£20.43 per m (45 x 20 mm section)
Floating sash		£122.46
Bottom running		£8.19 per gate
Low profile 'I' track (silver anodised only)		no cost option
Lock post to suit Euro profile lock		no cost option (without lock)
Half cylinder Euro profile lock		£11.64 fitted
Full cylinder Euro profile lock		£23.05 fitted
Slam lock and post		£99.43
Available component parts		
Top track per metre	Code: YGA43050	£16.78 per linear metre
Bottom track 'W' per metre	Code: YGA02150	£17.20 per linear metre
Replacement lock	Code: YGA133L0	£40.85 (specify keyed alike/different)
Lock post	Code: YGA03150	£5.29 per metre



THIS PRODUCT CAN BE POWDER COATED
See page 66

SeceuroGuard 1000 can be supplied in Band A & B colours at no extra charge. See page 66 for further details. For external applications, a dark colour is recommended.

***Please note:** Folding tracks with a length of 600 mm or more are supplied with a retaining pin as standard. This is located between 488 mm and 568 mm from the ground regardless of track length. The retaining pin projects 60 mm beyond the lock post when the track is lowered and 30 mm when raised. If the width of the gate is greater than the height check that there will be sufficient room for the bottom track to fold up into.

There is an extra lead time for component gate sections, please call 01524 772400 for details.

FACE FIXED SIDE ELEVATION

The standard arrangement for a face fitted gate is as shown with the top track and sides face fixed and the bottom track reveal fixed. When ordering please identify clearly how each side of the frame will be fitted. Importantly, the size of your order will be manufactured to a height including fixing frame(s).

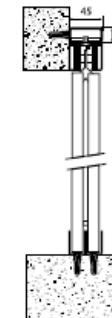

Bunch Sizes

All clear opening sizes for single sash gates allow for the slam post. For hinge aside gates or folding bottom tracks, the bunch size is increased by a further 60 mm per sash

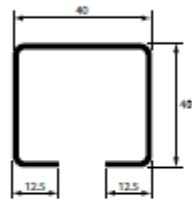

Top Track

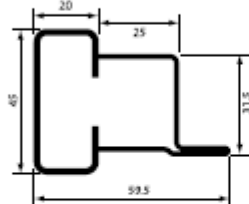

Single Sash Slam Post

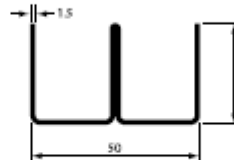

Bottom "W" Track



Bottom "T" Track

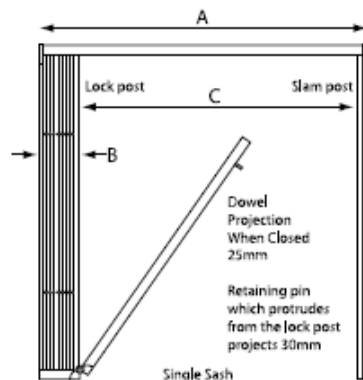

Single Sash

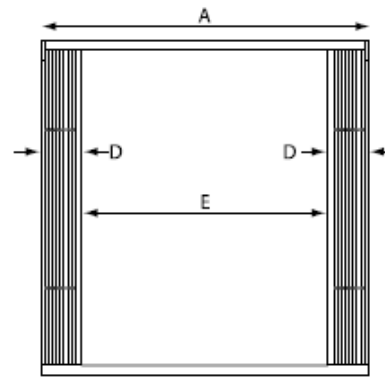

Double Sash

SeceuroGuard 1000 Retractable Security Gate

Common Use : Internal medium to high security domestic and selected commercial and retail applications. Made to measure in powder coated pre-galvanised steel.

CONSTRUCTION

Lattice : High grade steel in 'X' lattice as standard and 'S' lattice as an option.
Weight : 19kgm² nominal.
Stock colours : 40 colours available as standard stock finishes.

SIZES

Maximum Height : 3500mm.
Minimum Height : 500mm.
Maximum Width : Unlimited (See below).
Minimum Width : No minimum.

CE Marking : Fulfil all requirements of BSEN 13241-1

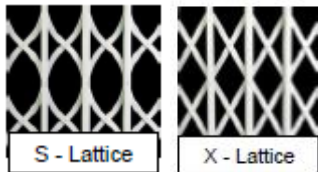

Folding Bottom Track



GENERAL ARRANGEMENT

1. Top hung on nylon coated steel bearings.
2. All galvanised steel construction.
3. Powder coating in a range of colours.
4. Fits within or around the reveal.
5. Multi-point locking from a single key – 2 point.
6. Strong steel lattice with smooth durable finish.
7. Overlapped locking profiles.
8. Optional folding bottom track.
9. Steel riveted lattice assembly system.

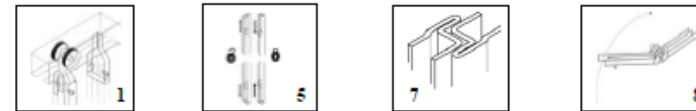

Please note: SeceuroGuard 1000 can accommodate an unlimited width with multiple sashes. Sashes are made in single pieces up to 2m wide. Larger sizes are made in sections for assembly on site, ensuring the weight of each section can be handled safely. Gates which are wider than 4m will be supplied with the top track in two pieces, the split will be in the middle. Where two split sashes meet two pickets are joined together using bolts and fixing plates supplied loose.

*SeceuroGuard is also available in an insurance approved version, SeceuroGuard 1001.

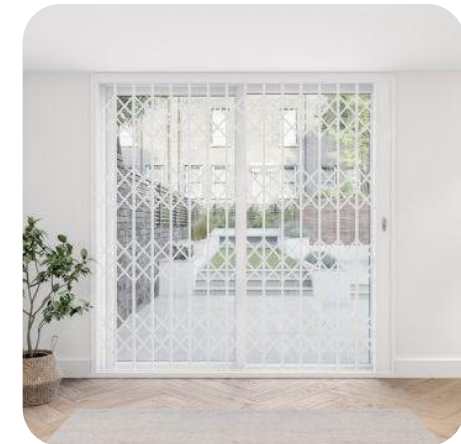

Technical specification

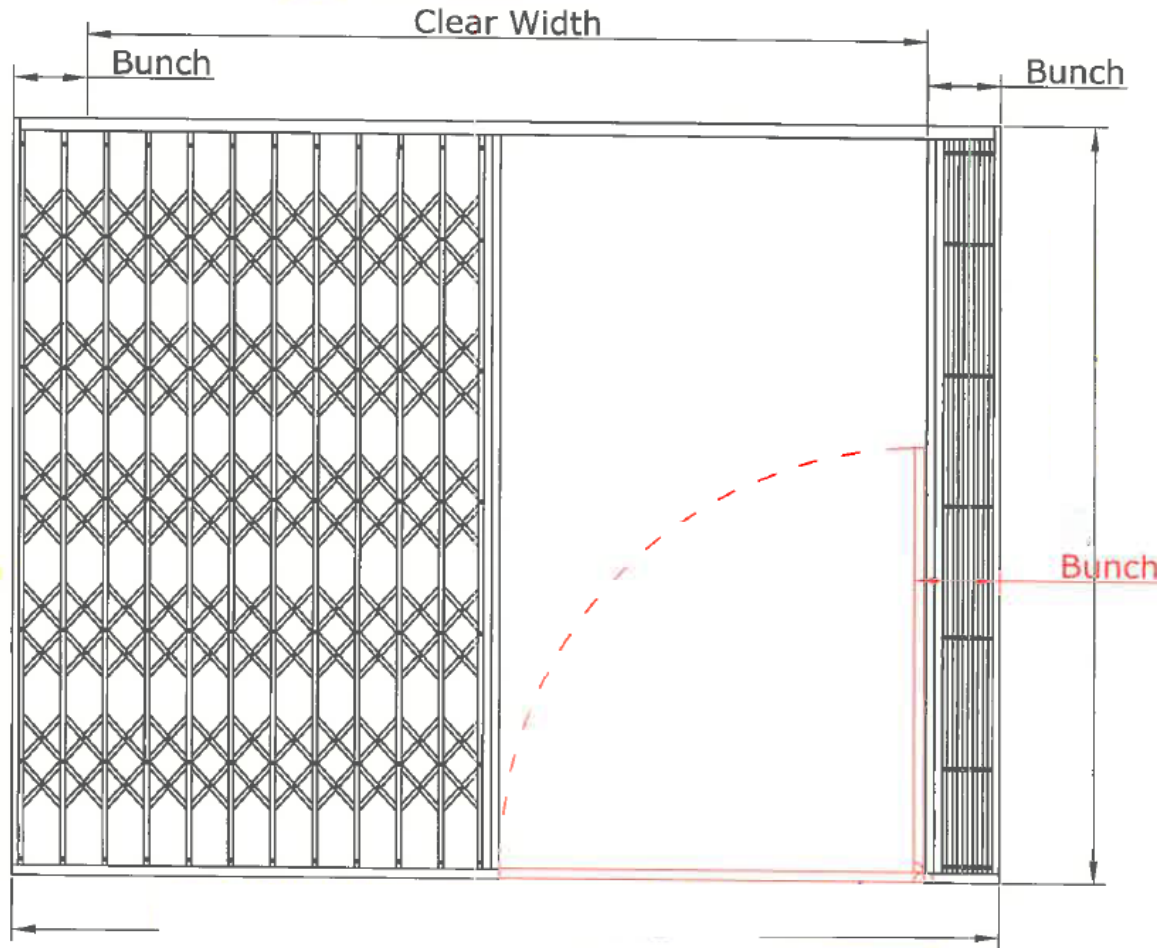

*figures quoted above are example only, drawings readily available specific to quote via your SWS UK online portal